

# LACAVA®

## CIGNO Volume Control Item #1510 (.5/.75)



### Features:

- Built-in stop valve with cross handle and round escutcheon
- Brass construction with single ceramic cartridge
- Includes rough-in and trim
- Flow rate: 12 GPM at 43.5 PSI
- Meets and exceeds the following standards/codes:
  - ASME A112.18.1-2012/CSA B125.1-12
  - CMR 248 (Mass. Code of Approval)
- It can be installed to meet ADA compliance
- Freight class 1 based on the Lacava Freight Program

### Recommended Accessories:

- Item #1545: Built in thermostatic valve with cross handle and round backplate

### Finish Options:

- CR - Polished Chrome
- PN - Polished Nickel
- NI - Brushed Nickel
- BG - Brushed Gold
- 44 - Matte Black

### Valve Options:

- 1510.5 - 1/2" F NPT inlet and outlet
- 1510.75 - 3/4" F NPT inlet and outlet

### Parts:

- R026 - Replacement ceramic cartridge for 1510.5
- R028 - Replacement ceramic cartridge for 1510.75
- R1510EX - 1 3/16" extension kit

### Product Specifications:

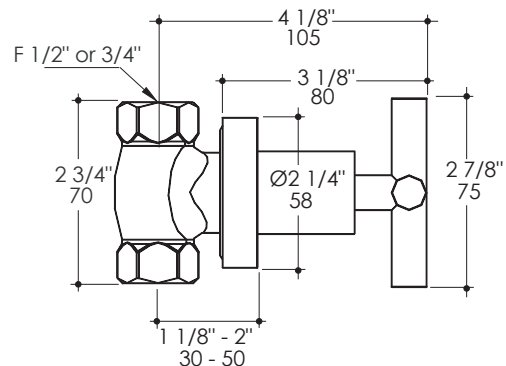

### Notes:

Drawings provided herein are meant to give the user an idea of the product and are not made to scale. The size in inches is rounded up to the nearest 1/16".

LACAVA is committed to the highest level of customer service. Please feel free to contact us at 1-888-522-2823 (toll free) or by email at [info@lacava.com](mailto:info@lacava.com) for technical assistance or any general inquiries.

Rev. 05-17-2017